

## IP68 Solenoid Valve SW1010 Series (G3/8", G1/2", G3/4", G1", G1 1/4", G1 1/2", G2")

### GENERAL FEATURES

- Wide pressure range, flow rate and orifis options.
- Solenoid valves are used with filters.
- Solenoid valves can be mounted in any position without affecting its operation, coil to be used in a vertical position.

### Application:

- It is a type of coil and solenoid valve that can be used in aggressive environments in dusty environments, under 10 m underwater conditions, in places exposed to high humidity, in outdoor places such as rain and water.
- Our undercoats (IP68) which can work under water and in aggressive environments are supplied with 3 meter cable as standard and at the required size upon order.
- All of our solenoid valve variants can be produced as solenoid valves that can operate under aggressive environment and underwater.

Coil that can work in aggressive environment and under water;

- TORK Coils capable of working in underwater and aggressive environments, have TSE approved IP68 protection class (tested under water for 72 hours).
- IP68 Coil for aggressive environment and underwater applications. Coil sheet special material for corrosion resistance.
- In IP60 protection against Tox (IP6X) and against IPA8 (IPX8), IP68 protection condition is ensured in tests made according to TS3033 EN60529 Standard.
- Teflon coated solenoid valves are suitable for working under water and in aggressive environments.
- IP68 and Teflon coated solenoid valves capable of working under aggressive environment and under water are subjected to 350 hours salt test. The protection is of the requisite qualities and has passed the salt test, which has no problem in the Num.

Note: See the manual for product details.

### ELECTRICAL CHARACTERISTICS

Continuous Duty	: ED %100
Coil Insulation Class	: H (180°C)(IEC 85)
Coil Impregnation	: Polyester Fiber Glass
Ambient Temperature	: -10°C, +60°C
Protection Degree	: IP68
Electrical Safety	: IEC 335
Standard Voltages	: AC 12V 15VA, 24V 15VA, 48V, 15VA, 110V 15VA, 230V 15VA, 230V 24VA DC 12V 18W, 24V 18W, 48V,18W, 110V 18W

On request other voltages

Voltages Tolerance	: AC -15%, +10% DC -5%, +10%
Frequency	: 50 Hz (60 Hz...)

Specify coil voltage with order

### MATERIALS IN CONTACT WITH FLUID

Body	: Brass (PTFE Coated)
Internal Parts	: Stainless Steel
Sealing	: NBR on request; EPDM, VITON
Shading Ring	: Copper (EN 12735-1)
Seats, Core Tube, Springs:	Stainless Steel

### OPTIONS

Female connection: BSP; (On request NPT)

### TECHNICAL FEATURES

Max. Viscosity	: 5°E (-37cST veya mm <sup>2</sup> /s)
Response Time	: Opening time : 400 ms -1600 ms Closing Time : 1000 ms -2000 ms

### SEALS FEATURES

NBR	: -10°C...+80°C
EPDM	: -10°C...+130°C
VITON	: -10°C...+160°C
PTFE	: -10°C...+160°C
RUBY	: -10°C...+160°C

### STANDARDS

- Standard tube connection G (BSP) (ISO 228-1) and other tube connections (NPT (ANSI 120.3)) are available on request.
- TORK solenoid valves 97/23/EC, are available for pressure equipment directive (PED) and 2006/95/ECC low voltage directive (LVD).



NORMALLY CLOSED

2 WAY

PILOT OPERATED

ΔP=0,5



WATER



AIR

Dimensions (mm)

	G	A	B	C	D	E	H	I	K
3/8"	72	97.7	32	45	94.8	76	109	52.5	
1/2"	80	99.2	32	45	96.2	76	110.5	52.5	
3/4"	78	106	32	45	97.2	76	117.3	52.5	
1"	85	112.5	32	45	98.7	76	123.8	52.5	
1 1/4"	106.5	124.5	32	45		76	135.8	72	
1 1/2"	128.5	137	32	45		76	148.3	95	
2"	149	149	32	45		76	160.3	109.7	

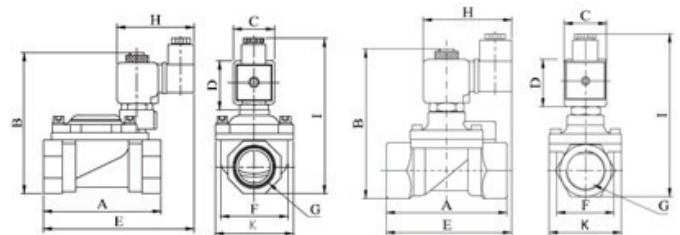

Coils	Nominal Values	Cold/ Hot	Inrush	Holding	Current (A)	Surface Temperature (°C)
C42012VDC18W	12VDC 18W	COLD	19,56	19,56	1,63	20
		HOT	14,52	14,52	1,21	106
C42024VDC18W	24VDC 18W	COLD	20,88	20,88	0,87	25
		HOT	14,64	14,64	0,61	116
C42110VDC18W	110VDC 18W	COLD	19,96	19,96	0,18	23
		HOT	13,56	13,56	0,123	115
C42012VAC15VA	12VAC 15VA	COLD	23,81	16,43	1,3	25
		HOT	-	15,86	1,262	79
C42024VAC15VA	24VAC 15VA	COLD	25,82	15,02	0,62	22
		HOT	-	13,91	0,57	81
C42110VAC15VA	110VAC 15VA	COLD	30,65	15,17	0,137	24
		HOT	-	13,96	0,126	80
C42230VAC15VA	230VAC 15VA	COLD	31,4	15,64	0,068	25
		HOT	-	14,41	0,063	80
C42230VAC15VA	230VAC 24VA	COLD	45,1	23,92	0,0154	23
		HOT	-	21,62	0,0154	100

Solenoid Valve Symbol	Valve Type/ Order No	Connection Size	Orifis Size	Pressure min/max		Kv	Seal	Option		Weight kg
				Bar	Bar			Viton	EPDM	
	SW1010	G	mm	Bar	Bar	l/min	NBR			
	SW1010.02.125	3/8"	12.5	0.5	16	48	✓	✓	✓	0,69
	SW1010.03.145	1/2"	14.5	0.5	16	70	✓	✓	✓	0,73
	SW1010.04.170	3/4"	17	0.5	16	90	✓	✓	✓	0,81
	SW1010.05.170	1"	17	0.5	16	90	✓	✓	✓	0,98
	SW1010.06.300	1 1/4"	30	0.5	12	250	✓	✓	✓	2,65
	SW1010.07.390	1 1/2"	39	0.5	12	270	✓	✓	✓	2,55
	SW1010.08.460	2"	46	0.5	12	450	✓	✓	✓	2,98